



DO-IT-YOURSELF OR PROFESSIONALLY INSTALLED STORAGE SHEDS



HILLSDALE
8-ft x 12-ft – See page 6



VALUE SERIES

Our most affordable storage solutions



STRATFORD

Do-It-Yourself:

- Floor materials sold separately

2x4 Treated Floor Joists (10) 8-ft, (2) 12-ft	3/4-in Floor Decking 3 sheets
--	----------------------------------

Installed:

- Includes floor system



BONUS FEATURES

- Window with shutters
- Two shelves
- Workbench
- Pegboard



RAINIER

Do-It-Yourself:

- Floor materials sold separately

2x4 Treated Floor Joists (11) 10-ft	3/4-in Floor Decking 4 sheets
--	----------------------------------

Installed:

- Includes floor system



BONUS FEATURES

- Storage loft provides 40% more storage space

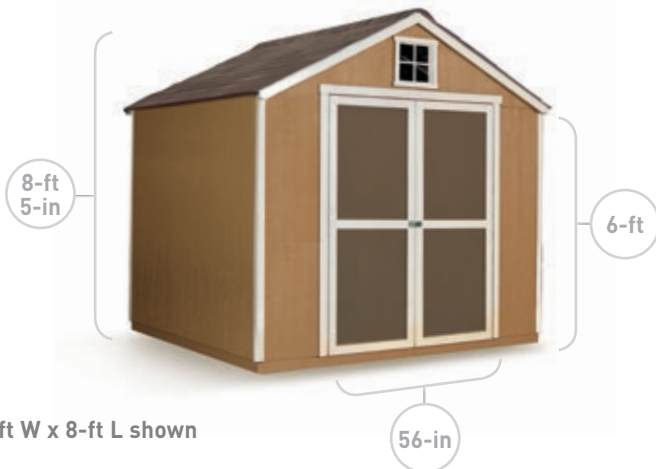

BELMONT

Do-It-Yourself:

- Floor materials sold separately

Size	2x4 Treated Floor Joists	3/4-in Floor Decking
8-ft x 8-ft	(9) 8-ft	2 sheets
8-ft x 10-ft	(9) 8-ft, (2) 10-ft	3 sheets

Installed:

- Includes floor system

BONUS FEATURES

- Gable window

8-ft W x 8-ft L shown

All stated sizes are nominal. Some models shown with optional accessories. See page 13 for more details.



SCOTTSDALE

Do-It-Yourself:

- Treated floor frame included – just add 1 sheet of floor decking

Installed:

- Includes floor system

BONUS FEATURES

- Heavy-duty keyed locking handle

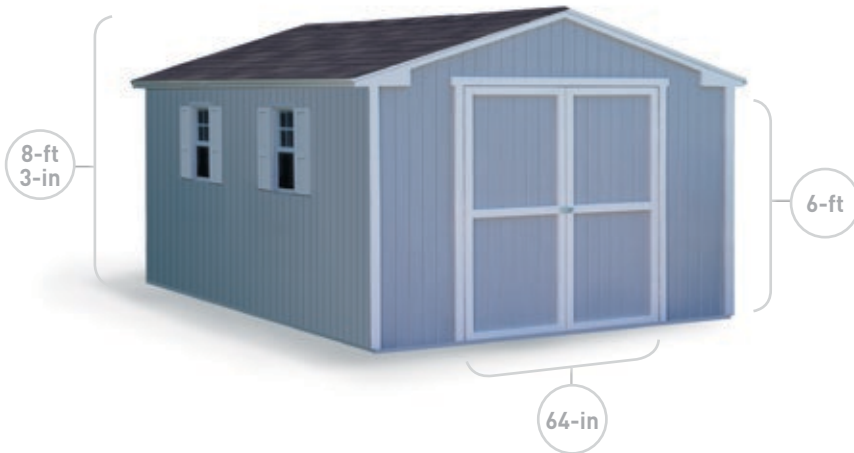

LIBERTY

Do-It-Yourself:

- Floor materials sold separately

Size	2x4 Treated Floor Joists	3/4-in Floor Decking
10-ft x 8-ft	(9) 8-ft, (2) 10-ft	3 sheets
10-ft x 12-ft	(11) 10-ft, (2) 12-ft	4 sheets

Installed:

- Includes floor system

10-ft W x 12-ft L shown with optional windows and shutters

Shed Model	Common Size W x L	Actual Interior Size Actual Foundation Size W x L	Sq Ft	Size Category	Do-It-Yourself†			Installed	Required (sold separately)		
					Item	Special Order Express	Model	Item	Exterior Latex Paint Trim Quarts	Siding Gallon	Shingles‡
Scottsdale	8-ft x 4-ft	8-ft x 4-ft	32	A	538356	562137	182464	562001	1	2	2
Belmont	8-ft x 8-ft	8-ft x 7-ft 8.625-in	64	A	437507	496842	182945	385509	1	2	4
Belmont	8-ft x 10-ft	8-ft x 9-ft 8.625-in	80	A	777552	777553	194030	716642	1	2	5
Liberty	10-ft x 8-ft	10-ft x 7-ft 8.625-in	80	A	441199	NA	184581	293118	1	1.5	4
Liberty	10-ft x 12-ft	10-ft x 11-ft 8.625-in	120	B	441200	NA	184598	293119	1	2	6
Stratford	12-ft x 8-ft	11-ft 9-in x 8-ft	96	B	437509	496841	182938	146278	1	2	5
Rainier	10-ft x 10-ft	10-ft x 9-ft 8.625-in	100	B	437510	496840	182921	293123	1	2	6

Size/Category: A: Under 80 sq ft B: 96–120 sq ft C: 144–288 sq ft D: Above 288 sq ft

†DIY shed available In-stock or Special Order Express

All stated sizes are nominal. ‡Asphalt or fiberglass shingles; 5 bundles cover 100 sq. ft. Some models shown with optional accessories. See page 13 for more details.

Patented EZ Frame™ construction reduces assembly time up to 30% compared to other wood building kits! (Patent No. 5,666,766) Stratford, Rainier and Liberty models only.

CLASSIC SERIES

Our best value — more storage, more features included



10-ft W x 12-ft L shown



BONUS FEATURES

- Complete floor system
- Storage loft
- Vents
- Window

ESTATE

Includes:

- Extra wide 64-in double doors
- 7-ft tall side walls

Shed Model	Common Size W x L	Actual Interior Size Actual Foundation Size W x L	Sq Ft	Size Category	Do-It-Yourself		Installed	Required (sold separately)		
					Item	Model	Item	Trim Quarts	Siding Gallon	Shingles‡
Estate	10-ft x 10-ft	10-ft x 10-ft	100	B	437569	183577	437574	1	2	6
Estate	10-ft x 12-ft	10-ft x 12-ft	120	B	319370	191008	84439	1	2.5	7
Estate	10-ft x 16-ft	10-ft x 16-ft	160	C	323873	191107	325242	1	3	10
Estate	12-ft x 12-ft	12-ft x 12-ft	144	C	80025	192456	111538	1	2.5	8
Estate	12-ft x 16-ft	12-ft x 16-ft	192	C	80030	192500	87775	1	3	11
Estate	12-ft x 20-ft	12-ft x 20-ft	240	C	80644	192555	88848	1	3	14
Estate	12-ft x 24-ft	12-ft x 24-ft	288	C	80708	192609	89722	1	4	15

Size/Category: A: Under 80 sq ft B: 96–120 sq ft C: 144–288 sq ft D: Above 288 sq ft

All stated sizes are nominal. ‡Asphalt or fiberglass shingles; 5 bundles cover 100 sq. ft. Some models shown with optional accessories. See page 13 for more details.



STATESMAN

Includes:

- Extra wide 64-in double doors
- 7-ft tall side walls



BONUS FEATURES

- Complete floor system
- Storage loft
- Two shelves
- Vents
- Gable Window

10-ft W x 12-ft L shown



GENTRY

Includes:

- Extra wide 64-in double doors
- 7-ft tall side walls



BONUS FEATURES

- Complete floor system
- Vents
- Window
- Shutters
- Storage loft
- Workbench
- Pegboard
- Shelf

12-ft W x 10-ft L shown

Shed Model	Common Size W x L	Actual Interior Size Actual Foundation Size W x L	Sq Ft	Size Category	Required (sold separately)					
					Do-It-Yourself		Installed	Exterior Latex Paint		Shingles‡
					Item	Model		Item	Trim Quarts	
Statesman	10-ft x 8-ft	10-ft x 8-ft	80	A	437571	183553	437575	1	2	5
Statesman	10-ft x 10-ft	10-ft x 10-ft	100	B	437572	183560	437576	1	2	6
Statesman	10-ft x 12-ft	10-ft x 12-ft	120	B	319371	191305	85205	1	2.5	6
Statesman	10-ft x 16-ft	10-ft x 16-ft	160	C	323874	191404	325264	1	3	8
Statesman	12-ft x 12-ft	12-ft x 12-ft	144	C	80832	192654	91031	1	2.5	7
Statesman	12-ft x 16-ft	12-ft x 16-ft	192	C	80972	192708	91254	1	3	10
Statesman	12-ft x 20-ft	12-ft x 20-ft	240	C	81391	192753	92703	1	3	12
Statesman	12-ft x 24-ft	12-ft x 24-ft	288	C	81392	192807	92947	1	4	13
Gentry	12-ft x 10-ft	12-ft x 10-ft	120	B	319369	191206	83287	1	2.5	6
Gentry	12-ft x 12-ft	12-ft x 12-ft	144	C	83367	192852	92983	1	2.5	7

Size/Category: A: Under 80 sq ft B: 96-120 sq ft C: 144-288 sq ft D: Above 288 sq ft

All stated sizes are nominal. ‡Asphalt or fiberglass shingles; 5 bundles cover 100 sq. ft. Some models shown with optional accessories. See page 13 for more details.

ARCHITECTURAL COLLECTION

High style, premium construction



PRESTWICK

Includes:

- Wide 56-in double doors
- 6-ft 4-in tall side walls



BONUS FEATURES

- Complete floor system
- Craftsman style corbels
- Deep roof overhangs



HILLSDALE

Includes:

- Flexible door and window placement
- Easy access 32-in side door
- Extra wide 64-in double doors
- 7-ft tall side walls



BONUS FEATURES

- Complete floor system
- Two windows
- Two arched gable vents
- Deep roof overhangs

**Side wall features
flexible door and window placement**



8-ft W x 12-ft L shown with optional premium cupola (sold separately)

Shed Model	Common Size W x L	Actual Interior Size Actual Foundation Size W x L	Sq Ft	Size Category	Do-It-Yourself		Installed	Required (sold separately)			
					Item	Model	Item	Exterior Latex Paint		Shingles‡	Drip Edge
								Trim Quarts	Siding Gallon		
Prestwick	8-ft x 10-ft	8-ft x 10-ft	80	A	703662	192326	716645	2	2	5	50
Hillsdale	8-ft x 12-ft	8-ft x 12-ft	96	B	703660	191022	716643	2	2	6	50
Hillsdale	10-ft x 12-ft	10-ft x 12-ft	120	B	703661	191114	716644	2	2.5	7	60

Size/Category: A: Under 80 sq ft B: 96-120 sq ft C: 144-288 sq ft D: Above 288 sq ft

All stated sizes are nominal. ‡Asphalt or fiberglass shingles; 5 bundles cover 100 sq. ft. Some models shown with optional accessories. See page 13 for more details.



METROPOLITAN

Includes:

- 8-ft tall front wall/6-ft tall back wall
- Extra wide 64-in double doors



BONUS FEATURES

- Complete floor system
- Two side wall windows
- Three overdoor transom windows
- Premium 3-point locking handle



MANSFIELD

Includes:

- Extra wide 64-in double doors
- 7-ft tall side walls

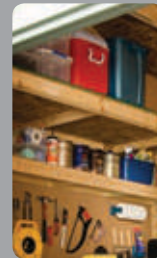

BONUS FEATURES

- Complete floor system
- Windows with shutters
- Flowerbox
- Loft
- Workbench
- Shelf
- Two arched gable vents
- Premium, 3 point locking handle

Shown with optional premium cupola (sold separately)

NOTE: Pegboard shown in inset is not included.
ALL MODELS: Drip edge must be installed to validate warranty.

Shed Model	Common Size W x L	Actual Interior Size Actual Foundation Size W x L	Sq Ft	Size Category	Required (sold separately)						
					Do-It-Yourself		Installed	Exterior Latex Paint		Shingles†	Drip Edge
					Item	Model	Item	Trim Quarts	Siding Gallon	Bundles	Linear Ft
Metropolitan	12-ft x 7-ft 6-in	12-ft x 7-ft 6-in	90	B	638506	191794	638507	2	2	5	70
Mansfield	12-ft x 10-ft	12-ft x 10-ft	120	B	638504	191466	638505	2	2.5	7	60

Size/Category: A: Under 80 sq ft B: 96–120 sq ft C: 144–288 sq ft D: Above 288 sq ft

All stated sizes are nominal. †Asphalt or fiberglass shingles; 5 bundles cover 100 sq. ft. Some models shown with optional accessories. See page 13 for more details.

LOW-MAINTENANCE VINYL SIDED BUILDINGS



The strength of wood combined with the benefits of vinyl siding



HAWTHORNE

Includes:

- Solid-vinyl double doors with wood-grain finish



BONUS FEATURES

- Complete floor system
- Steel strap hinges
- 3-point locking handle



BARRINGTON

Includes:

- Solid-vinyl double doors with wood-grain finish



BONUS FEATURES

- Complete floor system
- Window with screen
- Steel strap hinges
- 3-point locking handle

Shown with optional shutters

Shed Model	Common Size W x L	Actual Interior Size Actual Foundation Size W x L	Sq Ft	Size Category	DIY	Installed	Shingles‡
					Item	Item	Bundles
Hawthorne	8-ft x 8-ft	8-ft x 8-ft	64	A	NA	562002	NA
Barrington	10-ft x 8-ft	10-ft x 8-ft	80	A	NA	562003	NA

Size/Category: A: Under 80 sq ft B: 96–120 sq ft C: 144–288 sq ft D: Above 288 sq ft

All stated sizes are nominal. ‡Asphalt or fiberglass shingles; 5 bundles cover 100 sq. ft. Some models shown with optional accessories. See page 9 for more details.



10-ft W x 8-ft L shown with gable doors and optional gable vent

BONUS FEATURES

- Complete floor system
- Extended roof overhangs
- Premium upgraded, raised panel doors
- 3-point locking handle

MADISON  

Includes:

- Extra wide 64-in residential grade double doors
- 6-ft 6-in tall side walls
- Flexible door locations – eave or gable side

Vinyl Options	Installed
Description	Item
Vinyl Building Shutters – Black	293241
Vinyl Building Shutters – Green	293309
Vinyl Building Window	293237
Vinyl Building Gable Vent (Octagon)	293238
Vinyl Building – Extra Pair of Doors (Madison only)	121065

10-ft x 12-ft shown with eave doors, and optional window and shutters



VINYL COLORS

Standard Vinyl Siding Colors:

- White, Cream, Wicker and Clay
- White roof line trim and composite trim included with all siding colors

Additional Vinyl Colors Available:

- Sand, Light Gray, Maple and Dark Gray
- \$99 charge applies. See an associate for details.

Shed Model	Common Size W x L	Actual Interior Size Actual Foundation Size W x L	Sq Ft	Size Category	DIY	Installed	Shingles‡
					Item	Item	Bundles
Madison	10-ft x 8-ft	10-ft x 8-ft	80	A	NA	293139	NA
Madison	10-ft x 12-ft	10-ft x 12-ft	120	B	NA	293141	NA
Madison	10-ft x 16-ft	10-ft x 16-ft	160	C	NA	293142	NA

Size/Category: A: Under 80 sq ft B: 96–120 sq ft C: 144–288 sq ft D: Above 288 sq ft

All stated sizes are nominal. ‡Asphalt or fiberglass shingles; 5 bundles cover 100 sq. ft. Some models shown with optional accessories. See this page for more details.

BIG BUILDINGS

The ultimate in size and versatility



Not available in all markets



16-ft W x 24-ft L shown with optional windows. Inset shows 4-ft deep storage loft



VISTA

Includes:

- 8-ft tall side walls/12-ft 11-in peak
- Extra-wide 64-in double doors

BONUS FEATURES

- Complete floor system
- 16-in side wall stud spacing
- Felt and drip edge
- 4-ft deep storage loft

Shed Model	Common Size W x L	Actual Int. Size Actual Fnd. Size W x L	Total Floor Sq Ft	Size Category	DIY	Installed	Required (sold separately)		
					Item	Item	Trim Quarts	Siding Gallon	Bundles
Vista	16-ft x 16-ft	16-ft x 16-ft	256	C	NA	94028	4	4	NA
Vista	16-ft x 20-ft	16-ft x 20-ft	320	D	NA	293162	4	4	NA
Vista	16-ft x 24-ft	16-ft x 24-ft	384	D	NA	293163	4	5	NA

Size/Category: A: Under 80 sq ft B: 96-120 sq ft C: 144-288 sq ft D: Above 288 sq ft

All stated sizes are nominal. †Asphalt or fiberglass shingles; 5 bundles cover 100 sq. ft. Some models shown with optional accessories. See page 11 for more details.



16-ft W x 20-ft L shown with optional windows. Inset shows second story with stairs

Big Building Options	Installed
Description	Item
8-ft x 7-ft Sectional Garage Door	293230
6-ft6-in w x 6-ft4-in h Steel Roll-up Door	349426
Steel Service Door	293231
Wood Ramp - 8-ft x 5-ft	293232
16-ft x 4-ft Loft Section (Vista only)	293236

Big Building Options	Installed
Description	Item
16x16 Pro-Grade Floor System	840732
16x20 Pro-Grade Floor System	840733
16x24 Pro-Grade Floor System	840734
16-in x 24-in Fixed Gable Window	39119
Large Skylight	293220

SUMMIT

Includes:

- 8-ft tall side walls/19-ft 3-in peak
- Extra-wide 64-in double doors

BONUS FEATURES

- Complete floor system
- 16-in side wall stud spacing
- Felt and drip edge
- Full second story with stairs
- Faux hay loft door

Shed Model	Common Size W x L	Actual Int. Size Actual Fnd. Size W x L	Total Floor Sq Ft*	Size Category	Required (sold separately)					
					DIY Item	Installed Item	Exterior Latex Paint Trim Quarts	Siding Gallon	Shingles‡ Bundles	
Summit	16-ft x 16-ft	16-ft x 16-ft	392	C	NA	93112	4	5	NA	
Summit	16-ft x 20-ft	16-ft x 20-ft	452	D	NA	293160	4	5	NA	
Summit	16-ft x 24-ft	16-ft x 24-ft	512	D	NA	293161	4	6	NA	

Size/Category: A: Under 80 sq ft B: 96-120 sq ft C: 144-288 sq ft D: Above 288 sq ft *Includes 2nd story floor area

All stated sizes are nominal. †Asphalt or fiberglass shingles; 5 bundles cover 100 sq. ft. Some models shown with optional accessories. See this page for more details.

SOLAR SHED

Unique buildings to meet your needs



CUSTOMIZE
your shed

See this page



Shown with optional combination cedar bench, large window and wall vents

BONUS FEATURES

- Complete floor system
- 32-in wide door with locking handle
- Four aluminum roof windows
- 4 vents with adjustable air flow

HORIZON

Includes:

- 6-ft tall eave sidewall height and 9-ft high peak



Solar Shed Options	Do-It-Yourself		Installed
	Item	Model	Item
A Solar Shades (4)	344322	181597	146279
B Power Vent Fan	344317	181535	293261
C Combo Cedar Bench	344320	181511	293262

Shed Model	Common Size W x L	Actual Interior Size Actual Foundation Size W x L	Sq Ft	Size Category	Required (sold separately)					
					Do-It-Yourself†		Installed	Exterior Latex Paint		Shingles‡
					Item	Model	Item	Trim Quarts	Siding Gallon	Bundles
Horizon	10-ft x 8-ft	10-ft x 7-ft 8.625-in	80	A	344316	196355	293254	1	1.5	3

Size/Category: A: Under 80 sq ft B: 96-120 sq ft C: 144-288 sq ft D: Above 288 sq ft

All stated sizes are nominal. †Asphalt or fiberglass shingles; 5 bundles cover 100 sq. ft. Some models shown with optional accessories. See this page for more details.

STORAGE BUILDING ACCESSORIES

Size/Category: A: Under 80 sq ft B: 96-120 sq ft
C: 144-288 sq ft D: Above 288 sq ft

Customize your shed with functional accessories

Do-It-Yourself and Installed

					Available Accessories						
					Value Series	Classic Series	Architectural Collection	Vinyl Buildings	Big Buildings		
		Do-It-Yourself		Installed							
		Item	Model		Item						
Windows	Description										
		16-in x 24-in Small Window† ★	344280	188107		293187	■	■	■		■
		16-in x 24-in Shutters/Flowerbox‡	99164	188725		73069	■	■	■		■
		22-in x 30-in Large Window‡	344282	188114		293190	■	■	■	pgs. 8-9	■
		22-in x 30-in Shutters/Flowerbox‡	97257	188718		49167	■	■	■		■
	16-in x 24-in Fixed Gable Window (Gambrel Only)	344309	188022		39119		■			■	
Miscellaneous		Decorative Cupola with Rooster Weathervane	344284	188176		293193	■	■	■	■	■
		Premium Louvered Cupola, all sizes	638428	194023		638421	■	■	■	■	■
		Metal Ramps (Pair) ★	344286	188152		293221	■	■	■	■	■
		Venting Skylight ★	344285	188251		293219	■	■	■	■	■

Installed only

					Installed		Value Series	Classic Series	Architectural Collection	Vinyl Buildings	Big Buildings
						Item					
		Description									
Lofts		10-ft x 4-ft Storage Loft (Gambrel Only)		293200				■			
		12-ft x 4-ft Storage Loft (Gambrel Only)		293202				■			
Shelves/Workbenches		8-ft x 24-in Workbench‡		293206	■	■	■	■	■	■	■
		10-ft x 24-in Workbench‡		293207	■	■	■	■	■	■	■
		12-ft x 24-in Workbench‡		293208	■	■	■	■	■	■	■
		8-ft x 12-in Shelf‡		293203	■	■	■	■	■	■	■
		10-ft x 12-in Shelf‡		293204	■	■	■	■	■	■	■
		12-ft x 12-in Shelf‡		293205	■	■	■	■	■	■	■
Packages/Upgrades		16-in o.c. Wall Stud Spacing Upgrade from standard 24-in o.c. stud spacing	A	293216		■	■	■	■		Incl.
			B	293217		■	■	■	■		Incl.
			C	293218		■	■	■	■		Incl.
		Premium Package: ★ Includes Pro-Grade Floor System, Felt, Drip Edge, and Upgraded 10-Yr. Labor Warranty	A	841566	■	■	■	■	■		
			B	841567	■	■	■	■	■		
			C	841568	■	■	■	■	■		
		Pro-Grade Floor System ★ Heavy-duty treated floor upgrade - 35% more load capacity, features LP® ProStruct™ Treated Flooring	A	840729	■	■	■	■	■		pgs.10-11
			B	840730	■	■	■	■	■		pgs.10-11
			C	840731	■	■	■	■	■		pgs.10-11
		Felt & Drip Edge ★ Helps protect and extend the longevity of your roof	A	293196	■	■	■	■	■		Incl.
			B	293197	■	■	■	■	■		Incl.
			C	293198	■	■	■	■	■		Incl.
		Architectural Shingles Upgrade from standard 3 tab shingles. Limited Lifetime warranty.	A		■	■	■	■	■		■
			B		■	■	■	■	■		■
			C		■	■	■	■	■		■
			D		■	■	■	■	■		■
	Leveling Blocks ★	A	145215	■	■	■	■	■		■	
		B	145408	■	■	■	■	■		■	
		C	145411	■	■	■	■	■		■	
		D	638427							■	
Miscellaneous		Wall Vents (Pair) 8-in x 16-in ★		293213	■		Incl.	■			■
		4-ft Ridge Vent		184865	■		■	■	■		■
		Large Skylight		293220	■	■	■	■	■		■
		6-ft 6-in w x 6-ft 4-in h Steel Roll-up Door* <small>(offered on 10-ft wide Hillsdale, Gable & Gambrel Classics and 16-ft W Big Buildings)</small>		349426		■	■	■			■
		Premium Raised Panel Door Upgrade		293209		■	■	■†		Incl.**	■
		5-ft Treated Wood Ramp		293223	■	■	■	■	■		■
		Earth Anchors (4)		293225	■	■	■	■	■		■
		Generator Fee		123730	■	■	■	■	■		■
	Paint Program		121068	■	■	■	■	■		■	

★ = most popular accessory † not available on Prestwick model ‡ This option can only be installed on the side walls of the Value Series buildings. *This option can only be installed on gable side of building. **Madison only. ***Belmont, Stratford or Rainier models only.

PERGOLAS AND CEDAR GAZEBOS

Create your quintessential outdoor retreat



Architectural shingles shown

12-ft shown with optional two-tier roof and floor. Bench/tables, flowerboxes and cupola not included.

SEASIDE ROUND GAZEBO



- Tight-knot cedar is durable and decay-resistant
- Decorative spindles with metal cap and wooden finial
- 10-yr. limited material warranty
- 5-yr. labor warranty

Shed Model	Common Size W x L	Do-It-Yourself		Installed	Required (sold separately)	
		Item	Model		Exterior Stain Gallon	Shingles‡ Bundles
Seaside	10-ft round	344324	199448	293265	2	5
Seaside	10-ft round w/floor	344325	199431	293272	2	5
Seaside	12-ft round	344332	199486	293271	3	8
Seaside	12-ft round w/floor	344337	199493	293273	3	8

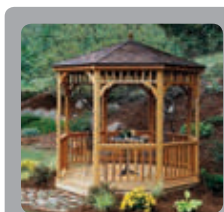

Seaside
10-ft Round
Shown with
optional floor

Gazebo Options Description	Do-It-Yourself		Installed Item
	Item	Model	
Screen Kit 10-ft round	344376	199387	293276
Screen Kit 12-ft round	344381	199363	293277
Two-Tier Roof 10-ft round	344399	199394	293280
Two-Tier Roof 12-ft round	344405	199509	293281

All stated sizes are nominal. ‡Asphalt or fiberglass shingles; 5 bundles cover 100 sq. ft. Some models shown with optional accessories. See this page for more details.



CATALINA PERGOLA

- Crafted from factory stained, preserved pine
- Decorative post caps and rafter ends
- Perfect combination of sun & shade
- 8-ft 9-in high
- 10-yr. limited material warranty
- 5-yr. labor warranty

Inside post to post:
9-ft 1-in x 11-ft 1-in

Overall size:
11-ft 6-in x 13-ft 6-in x 8-ft 9.5-in



PASADENA PAVILION

- Crafted from factory stained, preserved pine
- Perfect combination of sun & shade
- 9-ft 7-in high
- 10-yr. limited material warranty
- 5-yr. labor warranty

Overall size:
10-ft x 11-ft 3-in x 9-ft 7-in

Shed Model	Common Size W x L	Do-It-Yourself		Installed	Required (sold separately)	
		Item	Model		Exterior Stain	Shingles‡
Catalina	10-ft x 12-ft	245309	195457	245381	Gallon	Bundles
Pasadena	10-ft x 12-ft	245379	195501	245383	1	6

All stated sizes are nominal. ‡Asphalt or fiberglass shingles; 5 bundles cover 100 sq. ft. Some models shown with optional accessories. See this page for more details.

COMPARE EACH SERIES

NEED HELP? 1-800-577-9663

		Value	Classic	Architectural
Sizes	The widest variety of sizes to fit almost every need	32 sq ft – 120 sq ft	80 sq ft – 288 sq ft	80 sq ft – 120 sq ft
Wall framing	Economical 2x3 framing or premium 2x4 framing	2x3	2x4	2x4
Side wall height	Higher side walls provide more storage benefits	6-ft	7-ft	6-ft 4-in – 7-ft
Door opening	One of the largest standard door openings in the industry	56-in or 64-in (depending on model)	64-in	56-in or 64-in (depending on model)
Siding	LP® Siding: Treated wood siding resists termites and decay. Comes primed and ready to paint	LP® Siding	LP® Siding	LP® Siding
Warranty	Limited material warranty/ Labor warranty (installed only)	10-yr./1-yr.	12-yr./3-yr.	12-yr./3-yr.

CHOOSE THE PERFECT SIZE

A: Under 80 sq ft

Ideal for:

- Push mowers
- Lawn and garden tools
- Bikes
- Great for small yards

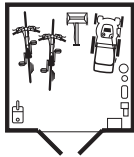

B: 96–120 sq ft

Ideal for:

- Lawn tractors
- Wheelbarrows
- Snow blowers
- Bulky equipment

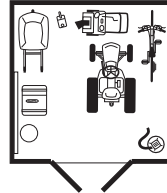

C: 144–288 sq ft

Ideal for:

- Motorcycles
- Snowmobiles
- Recreational vehicles
- Oversized equipment
- Also makes a great hobby/craft area

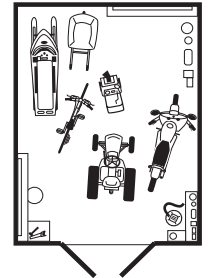

CHOOSE HOW TO BUY

DO-IT-YOURSELF



Pre-cut kit with pre-hung doors



No special carpentry skills needed



Floor system

Series	Floor
Value	Sold separately
Architectural	✓ Included
Classic	✓ Included

Floor materials, shingles & paint sold separately.

*Stocking assortment may vary by store. Special Order Express to Store. Special Order (SOS) – 21 days to Store. See a Lowe's Associate for pricing and availability. Some models shown with optional accessories. All stated sizes are nominal. Before finalizing your purchase, always contact your local building code authority and homeowner's association to check your local requirements. You may need to provide additional materials/modifications to meet your local requirements.

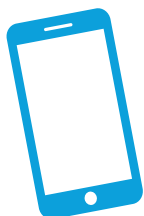

TEXT "SHEDS" TO 555888
for more information about our
DIY or Installed Storage Sheds

Terms & Privacy can be found at HeartlandLowe.com.
You may receive up to 4 msgs/month.
Message and data rates may apply. Reply STOP to end or HELP for help.

PROFESSIONAL INSTALLATION



Delivered & Installed



Shingles included



Floor system (with runners) included

Paint sold separately.

Installation may not be available in all areas. Heartland will install on customer's concrete slab in lieu of wood floor. No price adjustment or floor materials will be given due to additional labor and concrete anchors required. Slab must meet size and level requirements. Check with Heartland for details.

Optional Paint Program: Caulking of critical joints and painting with Valspar Storm Coat semi-gloss, exterior latex paint. Choose up to two colors (siding & trim) from the Valspar paint palette in the store. (Some colors are not available in Valspar Storm Coat.) Painting exterior surface of all siding and trim and all 6 sides of doors. Paint labor warranted for 1-yr. Not available for Gazebos, Pergolas or Vinyl-sided buildings. Heartland's building warranty requires all exposed surfaces to be painted within 30 days of installation. Please see store associate for details.

© Copyright 2019 Heartland Industries.
© 2019 by Lowe's. Lowe's, the gable design, and Never Stop Improving are trademarks of LF, LLC. All are used with permission. Materials and specifications subject to change without notice.

